

# DATA SHEET

## Transformer TDM S

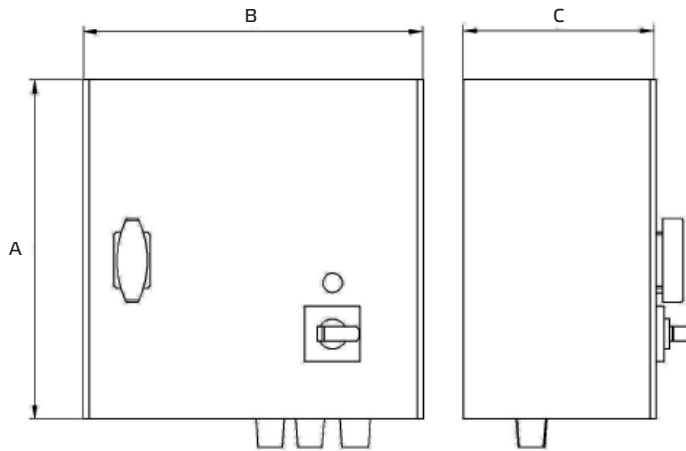

Type	ID	I <sub>max.</sub> A	A mm	B mm	C mm	D mm	E mm	Weight kg
<b>TDM 025S</b>	111575	2,5	325	300	175	255	255	12,5
<b>TDM 040S</b>	111576	4,0	425	300	175	255	355	18,1
<b>TDM 060S</b>	111577	6,0	425	300	235	255	355	21,8
<b>TDM 080S</b>	111578	8,0	425	300	235	255	355	27,0
<b>TDM 110S</b>	111579	11,0	430	400	235	355	355	36,6

- Transformer TDM S
- 400 V 3~, 50/60 Hz
- With motor protection
- With contact for damper motor
- Surface mounting
- Metal housing
- Max. ambient temp 35 °C
- Protection Class IP 54

Type	Output voltage U <sub>A</sub> V				
	1	2	3	4	5
<b>TDM 025S</b>	130	180	230	300	400
<b>TDM 040S</b>	130	180	230	300	400
<b>TDM 060S</b>	130	180	230	300	400
<b>TDM 080S</b>	130	180	230	300	400
<b>TDM 110S</b>	130	180	230	300	400

### Wiring diagram :



### Mounting :

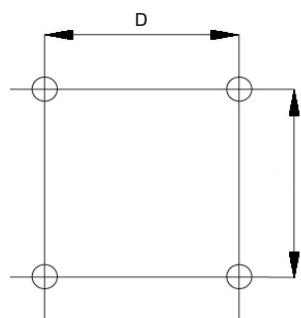

**Legend**  
U<sub>A</sub> = Output voltage  
I<sub>max.</sub> = Max. Operating Current