

Transformer TEM S

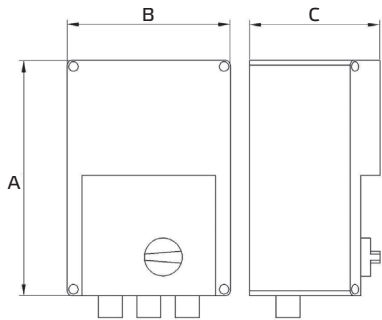

TEM 035S, TEM 050S
Plastic housing

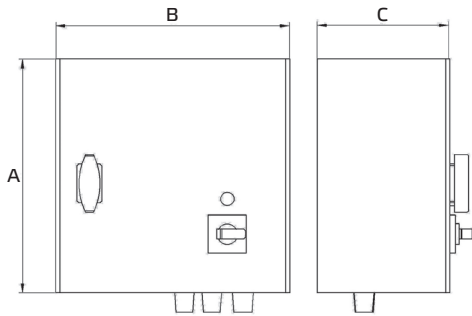

TEM 075S, TEM 100S, TEM 130S
Metal housing



Type	ID	I _{max.} A	Fuse A	A mm	B mm	C mm	D mm	E mm	Weight kg
TEM 035S	111582	3,5	5,0	255	170	140	155	194	4,6
TEM 050S	111583	5,0	8,0	255	170	140	155	194	5,3
TEM 075S	109729	7,5	12,5	305	200	140	183	236	7,8
TEM 100S	110763	10,0	16,0	325	300	185	255	255	12,6
TEM 130S	111584	13,0	18,0	325	300	185	255	255	15,1

- Transformer TEM S
- 230 V ~, 50/60 Hz
- With motor protection
- With contact for damper motor
- Surface mounting
- Max. ambient temp 35 °C
- Protection Class IP 54

Type	Output voltage U _A V				
	1	2	3	4	5
TEM 050S	110	140	170	200	230
TEM 050S	110	140	170	200	230
TEM 075S	110	140	170	200	230
TEM 100S	110	140	170	200	230
TEM 130S	110	140	170	200	230

Wiring diagram :

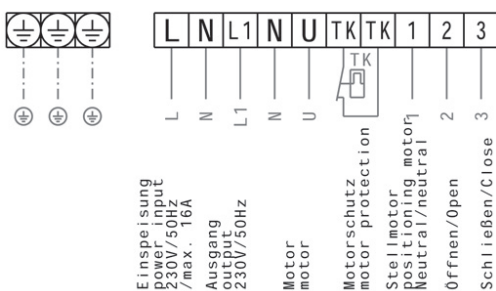

Mounting :

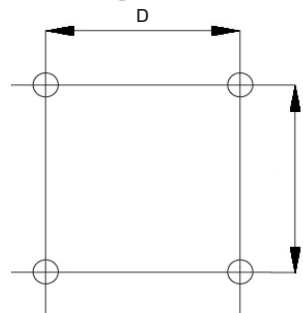

Legend
 U_A = Output voltage
 I_{max.} = Max. Operating Current